

## CAST STEEL OR STAINLESS STEEL KNIFE GATE VALVE ONE-PIECE BODY DESIGN

### DESIGN DESCRIPTION:

- Design: Factory STD;
- Manufacture: Factory STD;
- Face To Face: Factory STD;
- Flange: DIN2543/ANSI B16.5;
- Two-Piece Cast Steel Body;
- Threaded Hole Flanged Ends;
- Bolted Bonnet Out Stem And Yoke Type;
- Industry Application:
  - ◆ Paper Pulp, Sewage, Sand, Scoria, Lye, Heavery Medium Ganue;
  - ◆ Pressure Rating: PN10Bars
- Available With Handwheel, Electric, Pneumatic Actuation;
- Material and Working Temp.:
  - ◆ Cast Steel: -20 °C-400 °C(-4°F -752°F)
  - ◆ PTFE: 180 °C(356°F) Maximum
  - ◆ Stainless Steel Seal: 180 °C(356°F) Maximum



### PARTS AND MATERIAL:

NO.	PART NAME	MATERIAL
1	H.W.NUT	CARBON STEEL
2	HANDWHEEL	CAST IRON
3	STEM NUT	ZcuZn38Mn2Pb2
4	BEARING	BRASS/D2
5	YOKE HOLDER	ASTM A216-WCB/A351-CF8/CF8M
6	YOKE	CARBON STEEL
7	STEM	ASTM A275-F6a/F304/F316
8	KNIFE	SS304/SS316
9	BOLT	ASTM A193-B7/A193-B8
10	NUT	ASTM A194-2H/A194-8
11	UPPER GLAND	ASTM A216-WCB/A351-CF8/CF8M
12	PACKING	GRAPHITE+PTFE
13	BODY	ASTM A216-WCB/A351-CF8/CF8M
14	BODY BOLT	ASTM A216-WCB/A351-CF8/CF8M
15	SEAL HOLDER	ASTM A216-WCB/A351-CF8/CF8M
16	SEAL RING	EPDM/NBR/PTFE
17	PACKING	GRAPHITE+PTFE
18	BOTTOM GLAND	ASTM A216-WCB/A351-CF8/CF8M
19	BOLT	ASTM A193-B7/A193-B8
20	NUT	ASTM A194-2H/A194-8

OTHER MATERIALS ARE AVAILABLE UPON REQUEST.

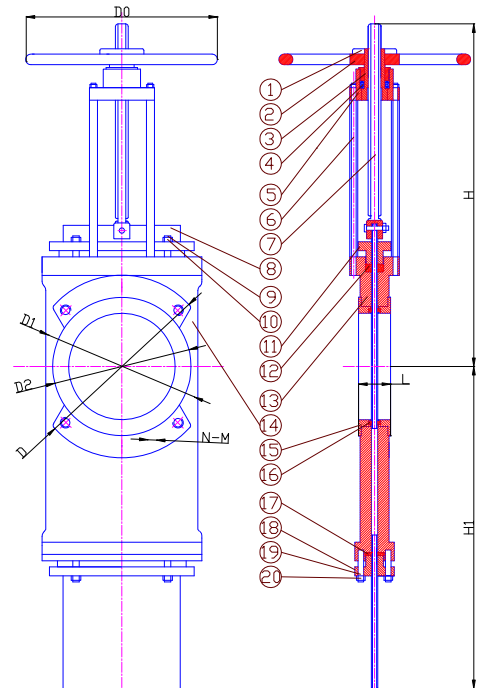

### DIMENSIONS LIST(UNIT:MM):

DN	L	DO	H	H1	DIN PN16				ANSI CL150			
					D	D1	D2	N-M	D	D1	D2	N-M
100	50.8	280	577	225	220	180	158	8-M19	229	190.5	157	8-M16
150	57.2	360	705	303	285	240	212	8-M20	280	241.3	216	8-M20
200	70	360	870	380	340	295	268	8-M20	343	298.5	270	8-M20
250	70	400	1015	460	405	355	320	12-M20	406	362	324	12-M22
300	76.2	400	1160	536	460	410	378	12-M20	483	431.8	381	12-M22
350	76.2	500	1307	613	520	470	438	16-M20	533	476.3	413	16-M27

✧ We hereby reserve the rights of any alternative dimension that would help to improve our valve's quality and working efficiency.